

2.5 Lock power module/frame power module

If desired, a *lock power module* and a *frame power module* can be used instead of batteries; see Figure 15 in section 2.5.7. The lock power module is inserted in the same way as the battery holder. The frame power module is a strike with an integrated LED circuit board. The strike can be configured for right or left hinges. For strike installation, see section 2.5.5.

Note: The lock power module should normally never be replaced. But if it is exchanged, connect Vostio Service Tool to the lock after the replacement to set the time.

2.5.1 Power supply/AC adapter

The power supply/AC adapter for the frame power module must fulfill the requirements below:

- Output voltage: 12/24V (10-30V)
- Output power: 1.5W minimum

The following AC adapters can be purchased from ASSA ABLOY Global Solutions:

Art.No	Name
P001312370-001-001	AC adapter, 15V, 3W, EU (for Europe)
P001312371-001-001	AC adapter, 15V, 3W, US (for North America)
P001312372-001-001	AC adapter, 15V, 3W, UK (for United Kingdom)
P001312373-001-001	AC adapter, 15V, 3W, AUS (for Australia)
P001312374-001-001	AC adapter, 15V, 3W, CH (for China)

Table 2

2.5.2 Power supply location

Position the power supply out of reach from hotel guests and other people except for qualified service personnel, to avoid it from being pulled out of the power outlet accidentally.

2.5.3 Cable between frame power module and power supply

The specification of cable between frame power module and AC adapter:

- Cable with 2 wires, 24-20AWG (0.2mm^2 - 0.5mm^2)

The following cable for use between frame power module and AC adapter can be purchased from ASSA ABLOY Global Solutions:

Art.No	Name
P001410594-001-001	Cable, white, 2 wires R/B, 24AWG
<i>Table 3</i>	

2.5.4 Prepare wire ends from power supply to lock power module

1. Remove the insulation as shown in Figure 11.
2. Twist the strands of the wire, to get it more rigid.

Note: Do not solder the wire ends - doing so will prevent a correct connection.

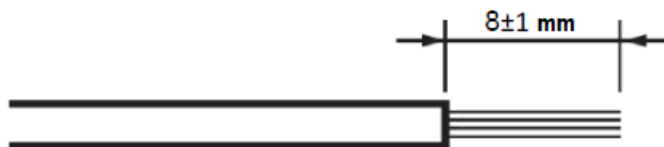

Figure 11

2.5.5 Install frame power module



Note: Make sure to mount the *magnet strike assy* with the grooves on the inside; see picture to the right below.

Note: When fastening the frame power module strike to the frame, make sure that the power cables have enough room as specified in the strike cut-out drawing ([D001354938-001](#)); also see Figure 12. Avoid that the wires are squeezed/damaged between the strike and the frame. See more about frame power module installation in Figure 15.

Figure 12

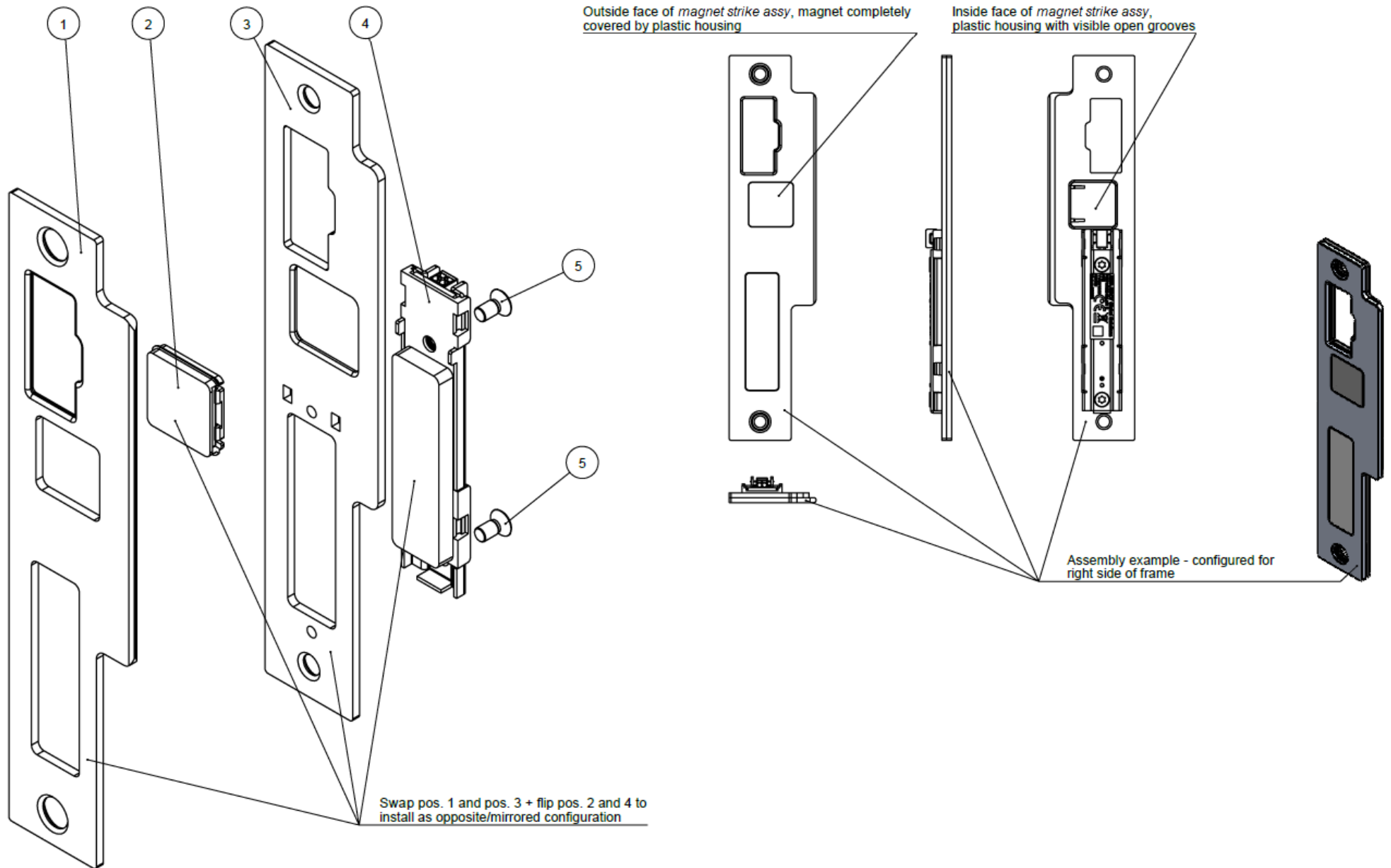

Figure 13

2.5.6 Connect frame power module to power cables

The terminal blocks on the frame power module are colored red for the positive wire and black for the negative. The terminal blocks are opened with fingers pushing the push button levers before inserting the wires.

When the power supply is connected with the correct polarity, a red status LED will light on the rear side of the frame power module (see Figure 14).

Note: If the wires have been connected with incorrect polarity, the frame power module will not be broken but will start working when the polarity has been corrected.

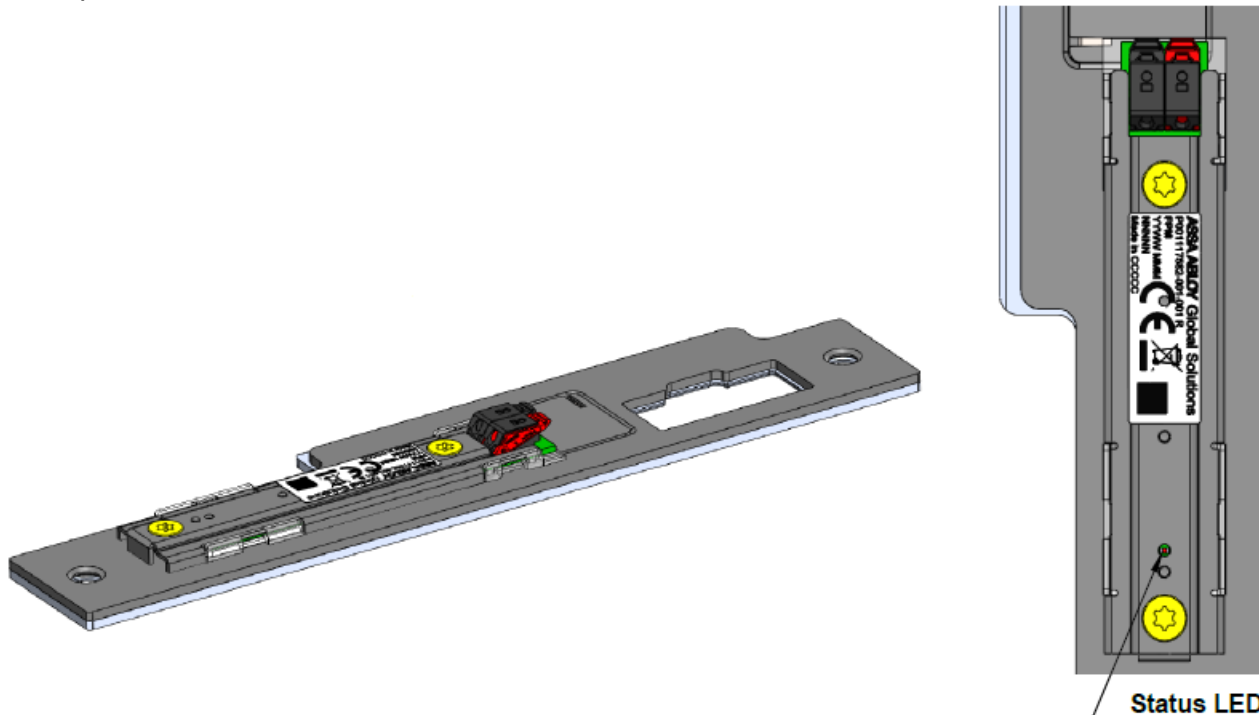

Figure 14

2.5.7 Install lock power module

See section 2.4 for the overall installation steps, but instead of mounting the batteries follow the steps below.

Note: For information about charging of super capacitor in lock power module, see *Quick reference guide VingCard Novel mortise lock*.

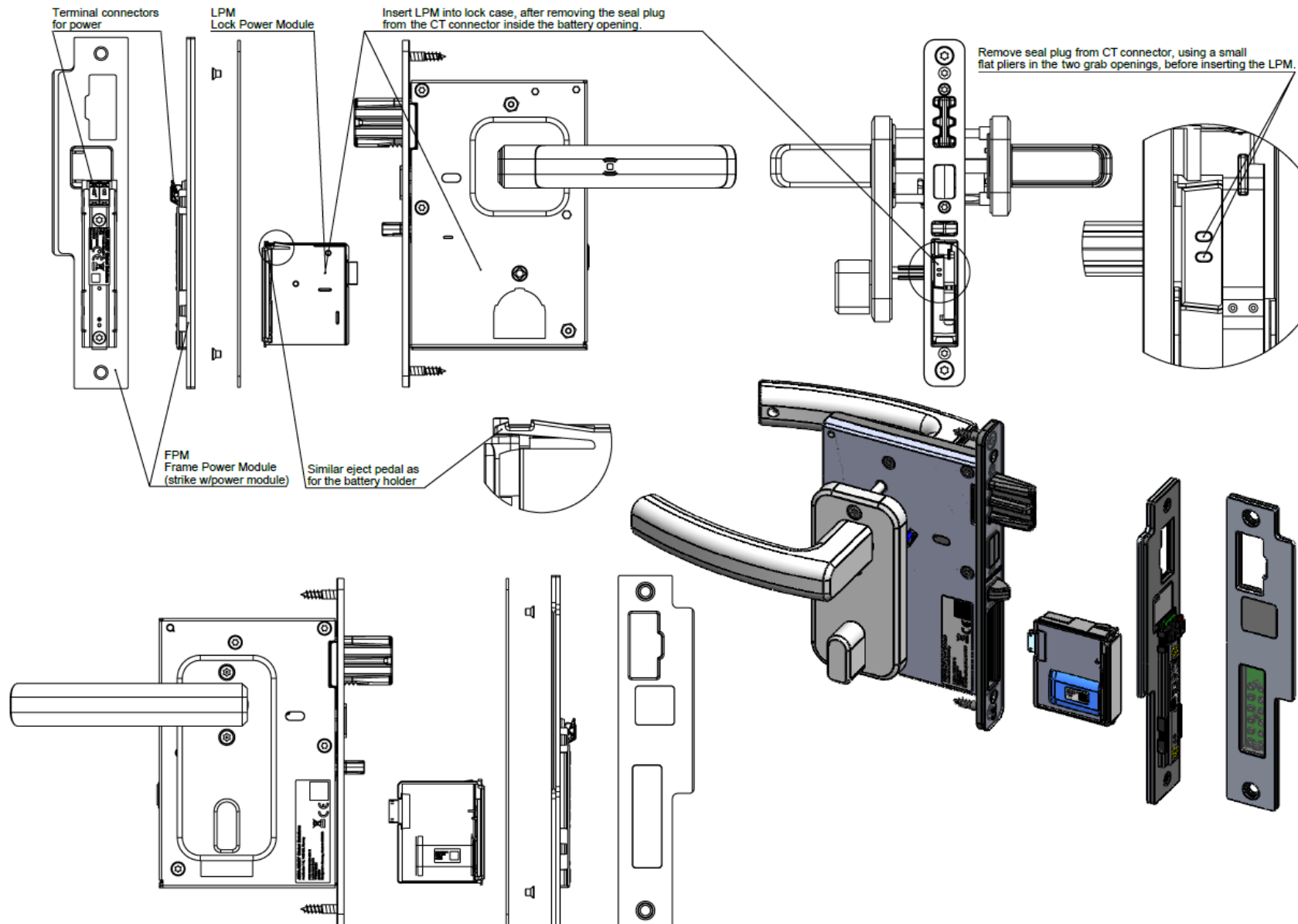

Figure 15